TABLE OF CONTENTS

Specifications	4-2
Quick Spec Guide	4-3
Elevations/Sizes: 1/4" Scale	
Roller Windows	4-4
Impact Roller Windows	4-8
Glazing Options: 3" Scale	4-9
Grille Patterns	4-10
Section Details: 6" Scale	4-11

PRODUCT SPECIFICATIONS

MATERIALS

The extruded vinyl profiles comply with the performance requirements of AAMA 303-97. Solid color extrusions are available in White and Desert Sand.

FRAME

All frames and sash are assembled using fusion-welding technology for added strength and durability. The frame jamb width is 3-1/4" (76.2mm), and the nominal extrusion exterior wall thickness is 0.070". The frame incorporates an integral nailing fin which can be easily removed to allow the unit to be used in a replacement window application. Weep holes are included on the sash to ensure standing water is directed to the exterior plane of the unit. An interior and exterior accessory groove is standard to accommodate various frame accessory and assembly options on the product. Optional frame types are: snap-in 5/8" flange, snap-in J-channel, snap-in Brickmould, and Box.

SASH

The sash is a 1-3/8" (35.18mm) nominal thickness, and is assembled using fusion-welding technology for added strength and durability. The sash also uses a steel reinforcement bar in the vertical meeting rails for additional strength. The fixed glass is direct-set into the unit frame.

GLAZING

7/8" (22.2mm) insulated glass consists of two lites of glass sealed around a spacer; 3/4" (19mm) insulated glass for SDL units. The glass is mounted into the sash using a silicone-glazing compound. The insulating glass units comply with the performance requirements of the IGCC in accordance with either ASTM E774 or E2190. All units are exterior glazed.

GLAZING OPTIONS

7/8" (22.2mm) or 3/4" (19mm) insulated glass is available in clear, Low-E or Low-E 366, tinted, obscure or other specialty insulating glass as specified. Many glass options are available in tempered glazing, ImpactGard®, or monolithic glass.

WEATHER-STRIPPING

A fin-pile weather-strip is applied along the perimeter of the operating sash and at frame sill.

HARDWARE

A single action cam style lock is available on all windows. Adjustable tandem brass wheels are housed at the base of the sash to allow for ease of operation. An anti-lift prevents the removal of the sash within a closed position.

INSECT SCREENS

The exterior fiberglass charcoal color insect screen is set in an aluminum frame to match the color of the unit. The spring loaded screen system assists in keeping it secured to the window. Insect screens are intended to allow air and light in and keep insects out. They are not intended to keep anyone or anything from falling through an open door or window. For safety screens or other security devices contact your local building supply retailer.

GRILLES

SDL (Simulated Divided Lite) 1" (25.4mm) color-matched extruded aluminum contour muntins surface mounted on the exterior surfaces of the insulated glass unit to provide a true divided lite appearance.

GBG (Grilles between the Glass) - 5/8" (16mm) and 7/8" (22.2mm) flat or 5/8" (16mm) contour grilles mounted between the glass panes suspended within the air cavity and color matched to the extrusion color.

EXTENSION JAMBS

Extension jambs are regionally available for JELD-WEN vinyl products. The 4-9/16 and 6-9/16" extension jambs are available in primed finger-joint and clear pine.

ADDITIONAL ACCESSORIES

Additional accessories are available for JELD-WEN Vinyl products. Please contact your local building supply retailer for a complete listing of the additional accessories. See www.jeld-wen.com/findsupplier.

INSTALLATION

See www.jeld-wen.com/resources for instructions.

PERFORMANCE

NFRC Certified - (rated and labeled in accordance with NFRC)

AAMA/NWDMA I.S.2-97

Please reference www.jeld-wen.com/performance ratings for up-to-date Design Pressure and approval information.

QUICK SPEC GUIDE

SPECIFICATION	STANDARD FEATURES	OPTIONAL FEATURES <i>Some options may require additional lead times. Consult your JELD-WEN Sales Representative.</i>
COLOR	<ul style="list-style-type: none"> White 	<ul style="list-style-type: none"> Desert Sand
SIZE	<ul style="list-style-type: none"> Width: 23-1/2" - 72-3/4" Height: 17-1/2" - 54" 	
FRAME	<ul style="list-style-type: none"> Nail Fin 	<ul style="list-style-type: none"> J-Channel Box Frame Brickmould 5/8" Flange 2-3/8" Flange Extender
GLAZING	<ul style="list-style-type: none"> 7/8" Insulated Clear 	<ul style="list-style-type: none"> Tempered Low-E Bronze Gray Green Obscure Azurlite Graylite (Turtle) Bronze Reflective
IMPACTGARD PROTECTION		<ul style="list-style-type: none"> PVB Impact PVB Impact Insulated SGP Impact Single-Glaze SGP Impact Standard Insulated SGP Impact ImpactGard Insulated <p style="text-align: center;"><i>Not available in tempered. PVB monolithic not available in Low-E. All other tint and obscure glazing options apply.</i></p>
HARDWARE	<ul style="list-style-type: none"> Locking Cam-Lock 	
HARDWARE COLOR	<ul style="list-style-type: none"> Matches Frame 	
SCREENS	<ul style="list-style-type: none"> Fiberglass 	
SCREEN FRAME COLOR	<ul style="list-style-type: none"> Matches Frame 	
GRILLES		<ul style="list-style-type: none"> SDL - 1" Simulated Divided Lite 5/8", 7/8" Flat GBG* 5/8" Contour GBG <p style="text-align: center;"><i>*Check for availability</i></p>
JAMB	<ul style="list-style-type: none"> 3-1/4" 	

ROLLER WINDOWS

UNIT SIZE	25 3/4" (654)	31 3/4" (806)	37 3/4" (959)	43 3/4" (1111)	49 3/4" (1264)	55 3/4" (1416)
ROUGH OPENING	24" (610)	30" (762)	36" (914)	42" (1067)	48" (1219)	54" (1372)
FRAME SIZE	23 1/2" (597)	29 1/2" (749)	35 1/2" (902)	41 1/2" (1054)	47 1/2" (1207)	53 1/2" (1359)
DAYLIGHT OPENING	8 5/8" (219)	11 5/8" (295)	14 5/8" (371)	17 5/8" (448)	20 5/8" (524)	23 5/8" (600)
	7 3/16" (183)	10 3/16" (259)	13 3/16" (335)	16 3/16" (411)	19 3/16" (487)	22 3/16" (564)
19 3/4" (502) 18" (457) 17 1/2" (445) 13 11/16" (348)						
25 3/4" (654) 24" (610) 23 1/2" (597) 19 11/16" (500)						
31 3/4" (806) 30" (762) 29 1/2" (749) 25 11/16" (652)						
37 3/4" (959) 36" (914) 35 1/2" (902) 31 11/16" (805)						
39 3/4" (1010) 38" (965) 37 1/2" (953) 33 11/16" (856)						
43 3/4" (1111) 42" (1067) 41 1/2" (1054) 37 11/16" (957)						
45 3/4" (1162) 44" (1118) 43 1/2" (1105) 39 11/16" (1008)						
49 3/4" (1264) 48" (1219) 47 1/2" (1207) 43 11/16" (1110)						

ELEVATION SYMBOL LEGEND:
 VALUES IN () ARE IN MILLIMETER CONVERSIONS.
 ### NUMBER INDICATES DESIGN PRESSURE (DP) RATING WITH STANDARD GLAZING.
 ###* NUMBER INDICATES OPTIONAL DESIGN PRESSURE (DP) RATING.
 E UNIT MEETS EGRESS REQUIREMENTS FOR IRC CODE. STATE AND LOCAL EGRESS CODES MAY DIFFER. ALWAYS REFER TO LOCAL BUILDING CODES FOR COMPLETE REQUIREMENTS. CHECK WITH LOCAL OFFICIALS TO ENSURE COMPLIANCE BEFORE INSTALLING THE UNIT.

SCALE: 1/4" = 1'

ROLLER WINDOWS

	25 3/4" (654)	31 3/4" (806)	37 3/4" (959)	43 3/4" (1111)	49 3/4" (1264)	55 3/4" (1416)		
UNIT SIZE	24" (610)	30" (762)	36" (914)	42" (1067)	48" (1219)	54" (1372)		
ROUGH OPENING	23 1/2" (597)	29 1/2" (749)	35 1/2" (902)	41 1/2" (1054)	47 1/2" (1207)	53 1/2" (1359)		
FRAME SIZE	8 5/8" (219)	11 5/8" (295)	14 5/8" (371)	17 5/8" (448)	20 5/8" (524)	23 5/8" (600)		
DAYLIGHT OPENING	7 3/16" (183)	10 3/16" (259)	13 3/16" (335)	16 3/16" (411)	19 3/16" (487)	22 3/16" (564)		
53 3/4" (1365) 52" (1321) 51 1/2" (1308) 47 11/16" (1211)								
	8RW2452	8RW3052	8RW3652	8RW4252	8RW4852	8RWS452		
	55 3/4" (1416) 54" (1372) 53 1/2" (1359) 49 11/16" (1262)							
		8RW2454	8RW3054	8RW3654	8RW4254	8RW4854	8RWS454	
		61 3/4" (1568) 60" (1524) 59 1/2" (1511) 55 11/16" (1414)						
			8RW2460	8RW3060	8RW3660	8RW4260	8RW4860	8RWS460

ELEVATION SYMBOL LEGEND:

- VALUES IN () ARE IN MILLIMETER CONVERSIONS.
- ##* NUMBER INDICATES DESIGN PRESSURE (DP) RATING WITH STANDARD GLAZING.
- ##** NUMBER INDICATES OPTIONAL DESIGN PRESSURE (DP) RATING.
- E UNIT MEETS EGRESS REQUIREMENTS FOR IRC CODE. STATE AND LOCAL EGRESS CODES MAY DIFFER. ALWAYS REFER TO LOCAL BUILDING CODES FOR COMPLETE REQUIREMENTS. CHECK WITH LOCAL OFFICIALS TO ENSURE COMPLIANCE BEFORE INSTALLING THE UNIT.

SCALE: 1/4" = 1'

ROLLER WINDOWS

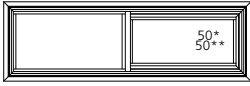
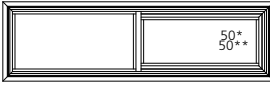
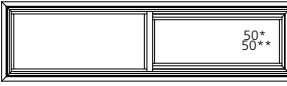
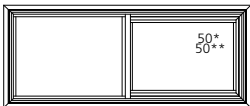
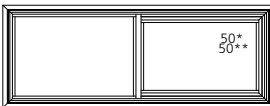
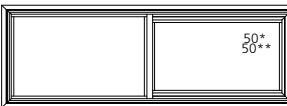
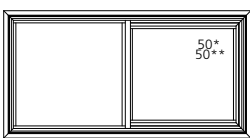
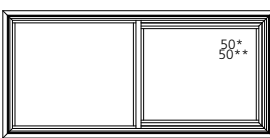
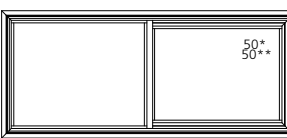
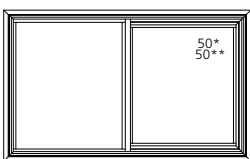
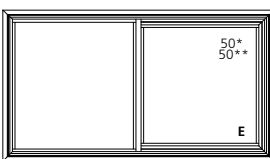
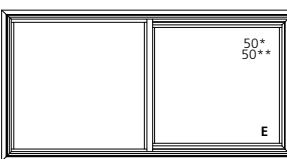
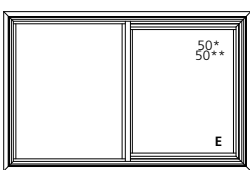
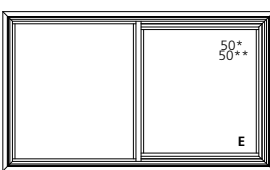
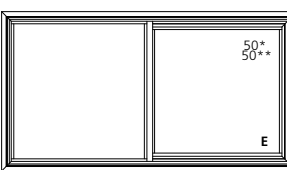
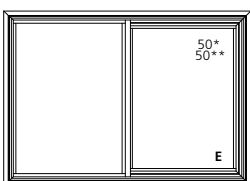
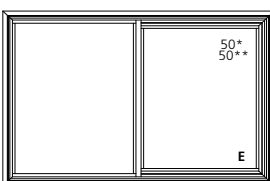
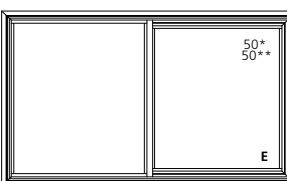
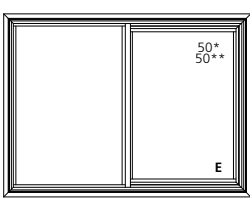
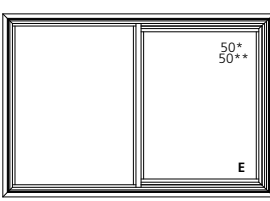
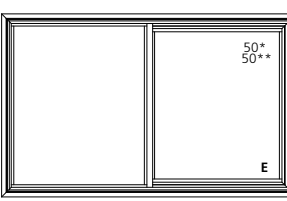
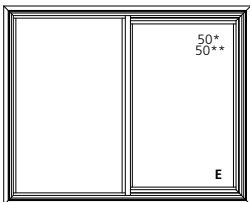
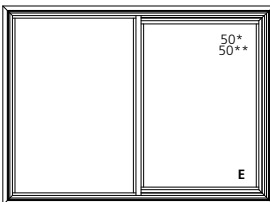
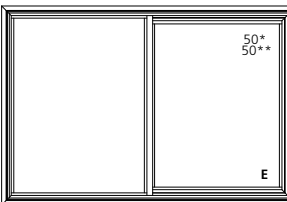
UNIT SIZE ROUGH OPENING FRAME SIZE DAYLIGHT OPENING	61 3/4" (1568) 60" (1524) 59 1/2" (1511) 26 5/8" (676) 25 3/16" (640)	67 3/4" (1721) 66" (1676) 65 1/2" (1664) 29 5/8" (752) 28 3/16" (716)	73 3/4" (1873) 72" (1829) 71 1/2" (1861) 32 5/8" (829) 31 3/16" (792)
19 3/4" (502) 18" (457) 17 1/2" (445) 13 11/16" (348)	 8RW6018	 8RW6618	 8RW7218
25 3/4" (654) 24" (610) 23 1/2" (597) 19 11/16" (500)	 8RW6024	 8RW6624	 8RW7224
31 3/4" (806) 30" (762) 29 1/2" (749) 25 11/16" (652)	 8RW6030	 8RW6630	 8RW7230
37 3/4" (959) 36" (914) 35 1/2" (902) 31 11/16" (805)	 8RW6036	 8RW6636	 8RW7236
39 3/4" (1011) 38" (965) 37 1/2" (953) 33 11/16" (856)	 8RW6038	 8RW6638	 8RW7238
43 3/4" (1111) 42" (1067) 41 1/2" (1054) 37 11/16" (957)	 8RW6042	 8RW6642	 8RW7242
45 3/4" (1162) 44" (1118) 43 1/2" (1105) 39 11/16" (1008)	 8RW6044	 8RW6644	 8RW7244
49 3/4" (1264) 48" (1219) 47 1/2" (1207) 43 11/16" (1110)	 8RW6048	 8RW6648	 8RW7248

ELEVATION SYMBOL LEGEND:

VALUES IN 0 ARE IN MILLIMETER CONVERSIONS.
 ##* NUMBER INDICATES DESIGN PRESSURE (DP) RATING WITH STANDARD GLAZING.
 ##** NUMBER INDICATES OPTIONAL DESIGN PRESSURE (DP) RATING.
 E UNIT MEETS EGRESS REQUIREMENTS FOR IRC CODE. STATE AND LOCAL EGRESS CODES MAY DIFFER. ALWAYS REFER TO LOCAL BUILDING CODES FOR COMPLETE REQUIREMENTS.
 CHECK WITH LOCAL OFFICIALS TO ENSURE COMPLIANCE BEFORE INSTALLING THE UNIT.

SCALE: 1/8" = 1'

ROLLER WINDOWS

UNIT SIZE
ROUGH OPENING
FRAME SIZE
DAYLIGHT OPENING

61 3/4" (1568)
 60" (1524)
 59 1/2" (1511)
 26 5/8" (676)
 25 3/16" (640)

67 3/4" (1721)
 66" (1676)
 65 1/2" (1664)
 29 5/8" (752)
 28 3/16" (716)

73 3/4" (1873)
 72" (1829)
 71 1/2" (1861)
 32 5/8" (829)
 31 3/16" (792)

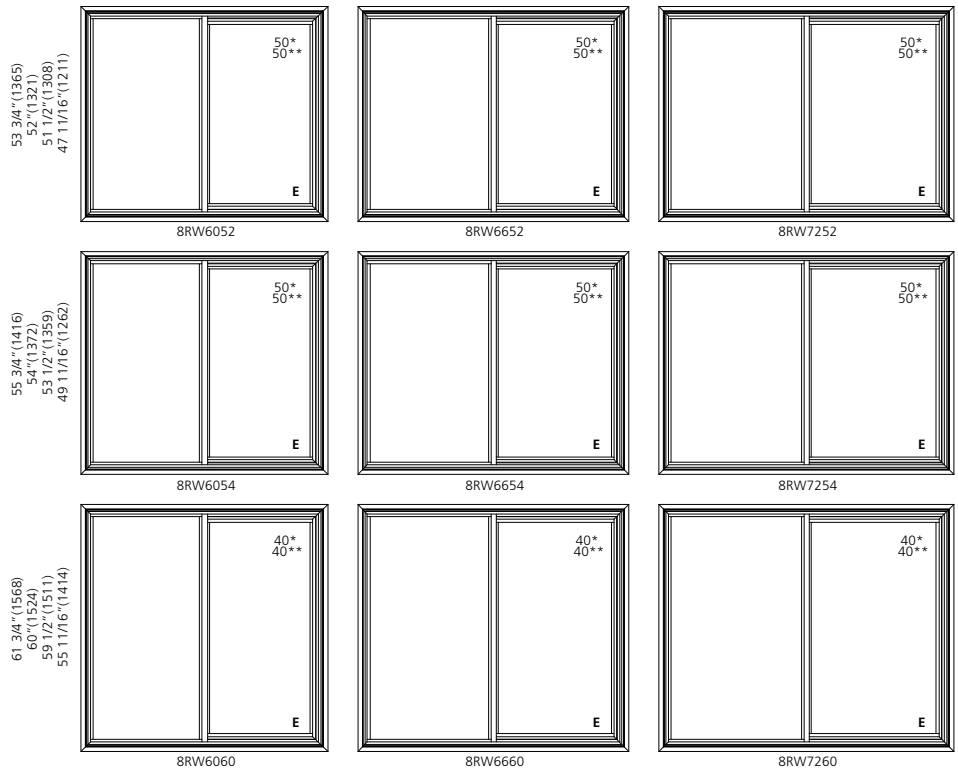

ELEVATION SYMBOL LEGEND:

VALUES IN () ARE IN MILLIMETER CONVERSIONS.

##* NUMBER INDICATES DESIGN PRESSURE (DP) RATING WITH STANDARD GLAZING.

NUMBER INDICATES OPTIONAL DESIGN PRESSURE (DP) RATING.

E UNIT MEETS EGRESS REQUIREMENTS FOR IRC CODE. STATE AND LOCAL EGRESS CODES MAY DIFFER. ALWAYS REFER TO LOCAL BUILDING CODES FOR COMPLETE REQUIREMENTS. CHECK WITH LOCAL OFFICIALS TO ENSURE COMPLIANCE BEFORE INSTALLING THE UNIT.

SCALE: 1/8" = 1'

**ROLLER WINDOWS - FLORIDA SIZES
 IMPACT**

	27 1/2"(699)	38"(965)	54 1/8"(1375)	75"(1905)
UNIT SIZE	27 1/2"(699)	38"(965)	54 1/8"(1375)	75"(1905)
ROUGH OPENING	24 3/4"(629)	36 1/4"(921)	52 3/8"(1330)	73 1/4"(1861)
FRAME SIZE	24 1/4"(616)	35 3/4"(908)	51 7/8"(1318)	72 3/4"(1848)
DAYLIGHT OPENING	9 1/2"(241)	14 1/4"(362)	22 13/16"(579)	33 1/4"(845)
	8 1/16"(205)	13 5/16"(338)	21 7/16"(545)	31 5/16"(795)
27"(686) 25 1/4"(641) 24 3/4"(629) 20 15/16"(532)				
	8RW-H32	8RW-22	8RW-32	8RW-D22
39 3/8"(1000) 37 5/8"(956) 37 1/8"(943) 33 5/16"(846)				
	8RW-H33	8RW-23	8RW-33	8RW-D23
51 5/8"(1311) 49 7/8"(1267) 49 3/8"(1254) 45 13/16"(1164)				
	8RW-H34	8RW-24	8RW-34	8RW-D24

ELEVATION SYMBOL LEGEND:

VALUES IN () ARE IN MILLIMETER CONVERSIONS.

##* NUMBER INDICATES DESIGN PRESSURE (DP) RATING WITH STANDARD GLAZING.

##** NUMBER INDICATES OPTIONAL DESIGN PRESSURE (DP) RATING.

E UNIT MEETS EGRESS REQUIREMENTS FOR IRC CODE. STATE AND LOCAL EGRESS CODES MAY DIFFER. ALWAYS REFER TO LOCAL BUILDING CODES FOR COMPLETE REQUIREMENTS. CHECK WITH LOCAL OFFICIALS TO ENSURE COMPLIANCE BEFORE INSTALLING THE UNIT.

SCALE: 1/8" = 1'

GLAZING OPTIONS

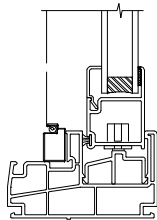

**3/4" IG
1/8" GLASS SIZE**

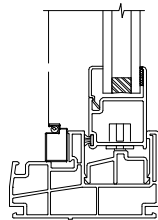

**3/4" IG
3/16" GLASS SIZE**

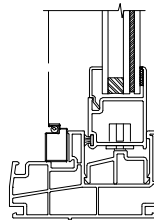

**3/4" LAMINATED GLASS
1/8" GLASS SIZE**

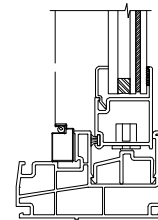

**3/4" LAMINATED GLASS
3/16" GLASS SIZE**

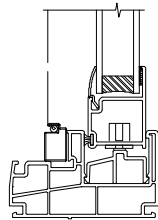

**7/8" IG
1/8" GLASS SIZE**

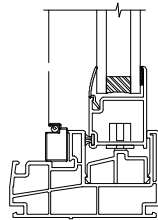

**7/8" IG
3/16" GLASS SIZE**

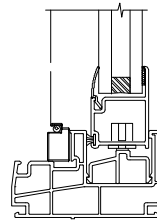

**7/8" IG
1/4" GLASS SIZE**

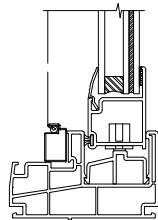

**7/8" IMPACT GLASS
1/8" GLASS SIZE**

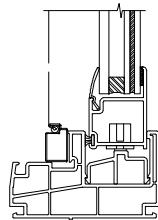

**7/8" IMPACT GLASS
3/16" GLASS SIZE**

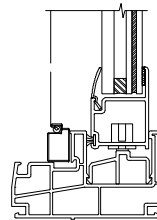

**7/8" IMPACT GLASS
1/4" GLASS SIZE**

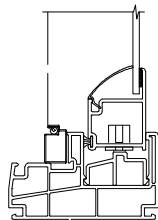

**SINGLE GLAZED
1/8" GLASS SIZE**

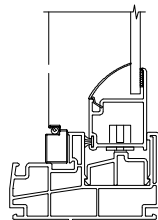

**SINGLE GLAZED
3/16" GLASS SIZE**

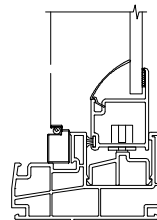

**SINGLE GLAZED
1/4" GLASS SIZE**

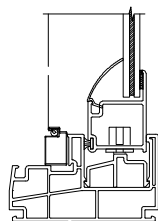

**SINGLE GLAZED IMPACT
1/8" GLASS SIZE**

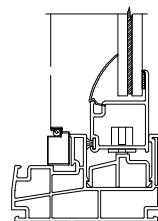

**SINGLE GLAZED IMPACT
3/16" GLASS SIZE**

SCALE: 3" = 1'

GRILLES PATTERNS

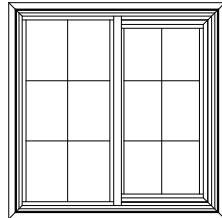

STANDARD

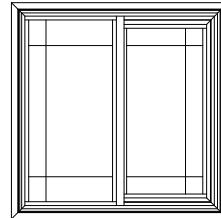

PRAIRIE

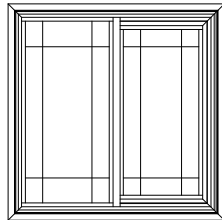

PRAIRIE SASH

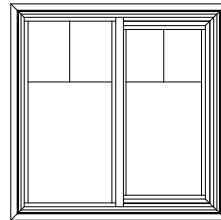

COLONIAL TOP 1/2

ROLLER WINDOW NAIL FIN

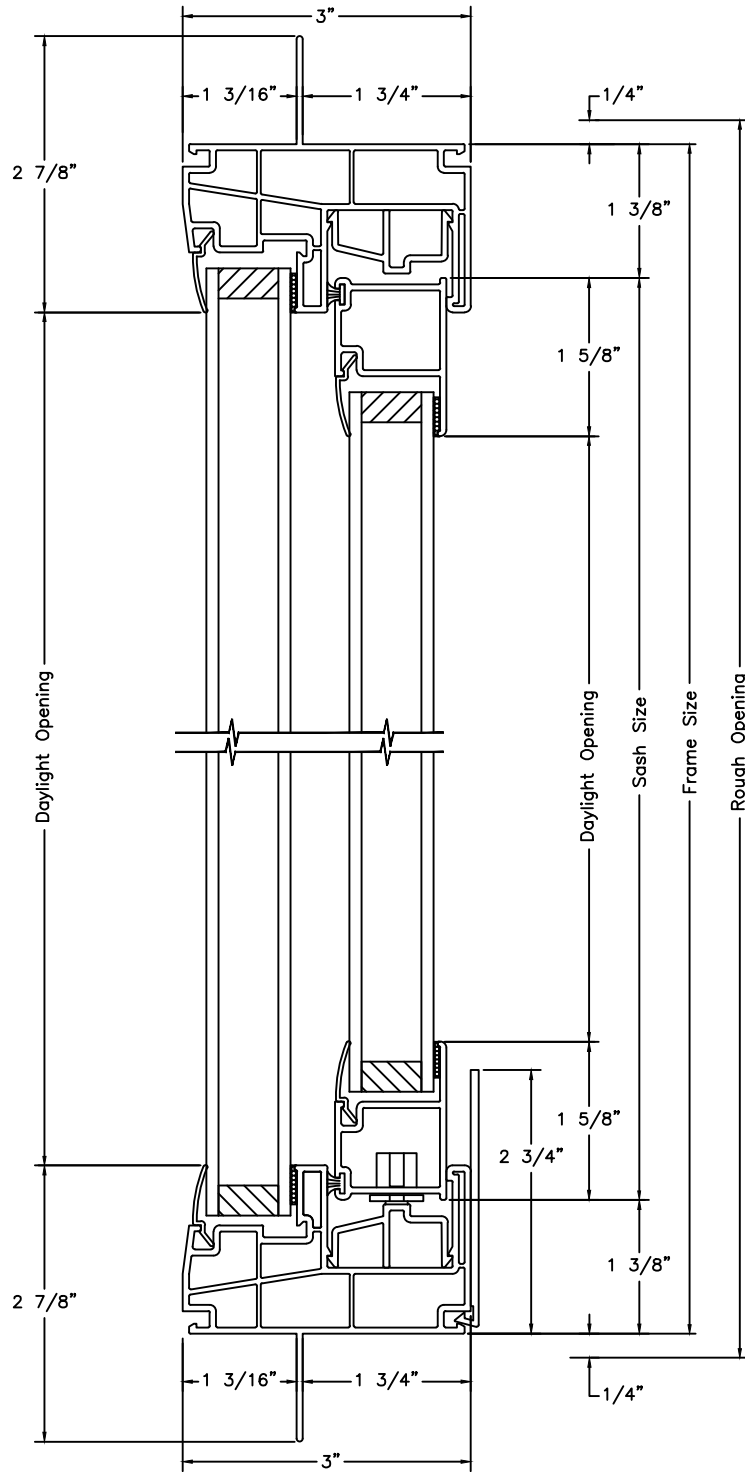

**ROLLER WINDOW
NAIL FIN**

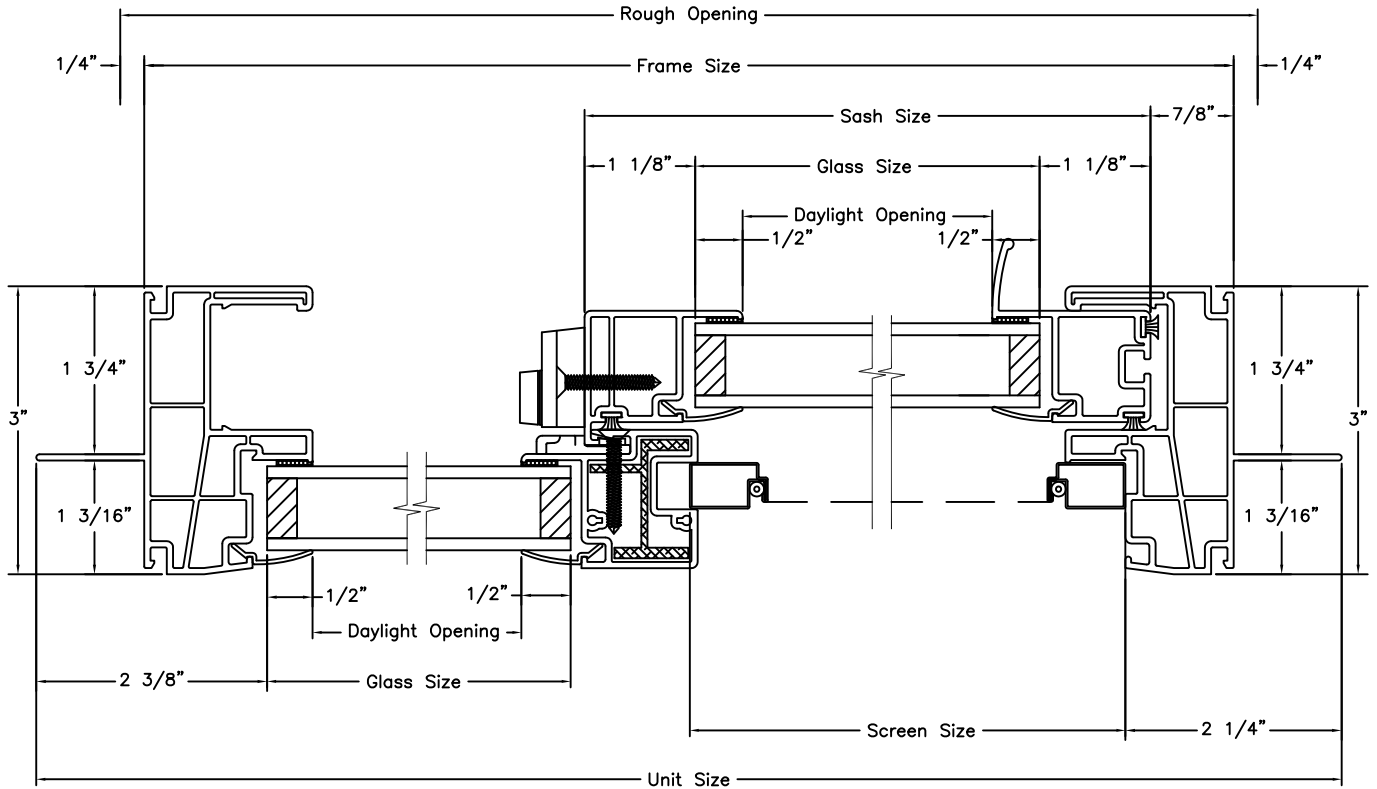

HORIZONTAL SECTION

ROLLER WINDOW FLANGE

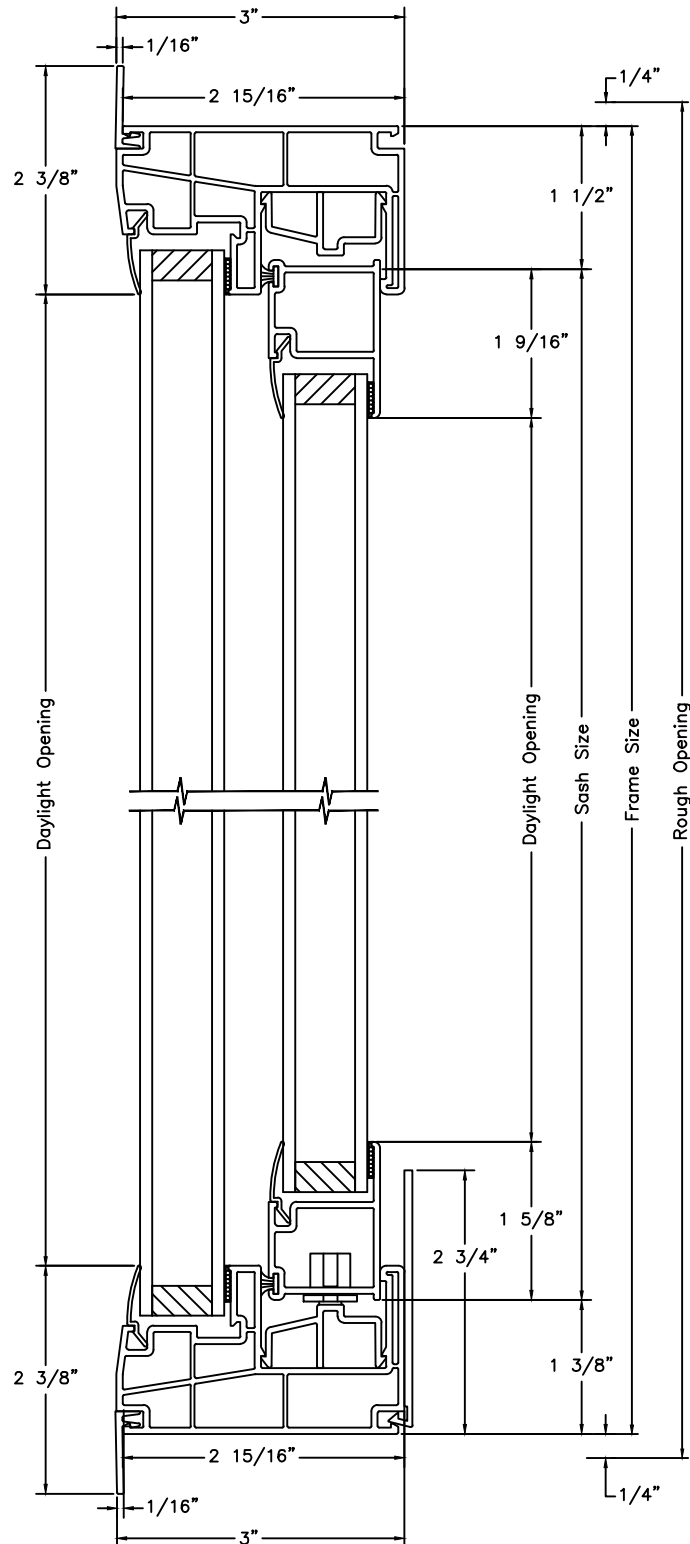

**ROLLER WINDOW
FLANGE**

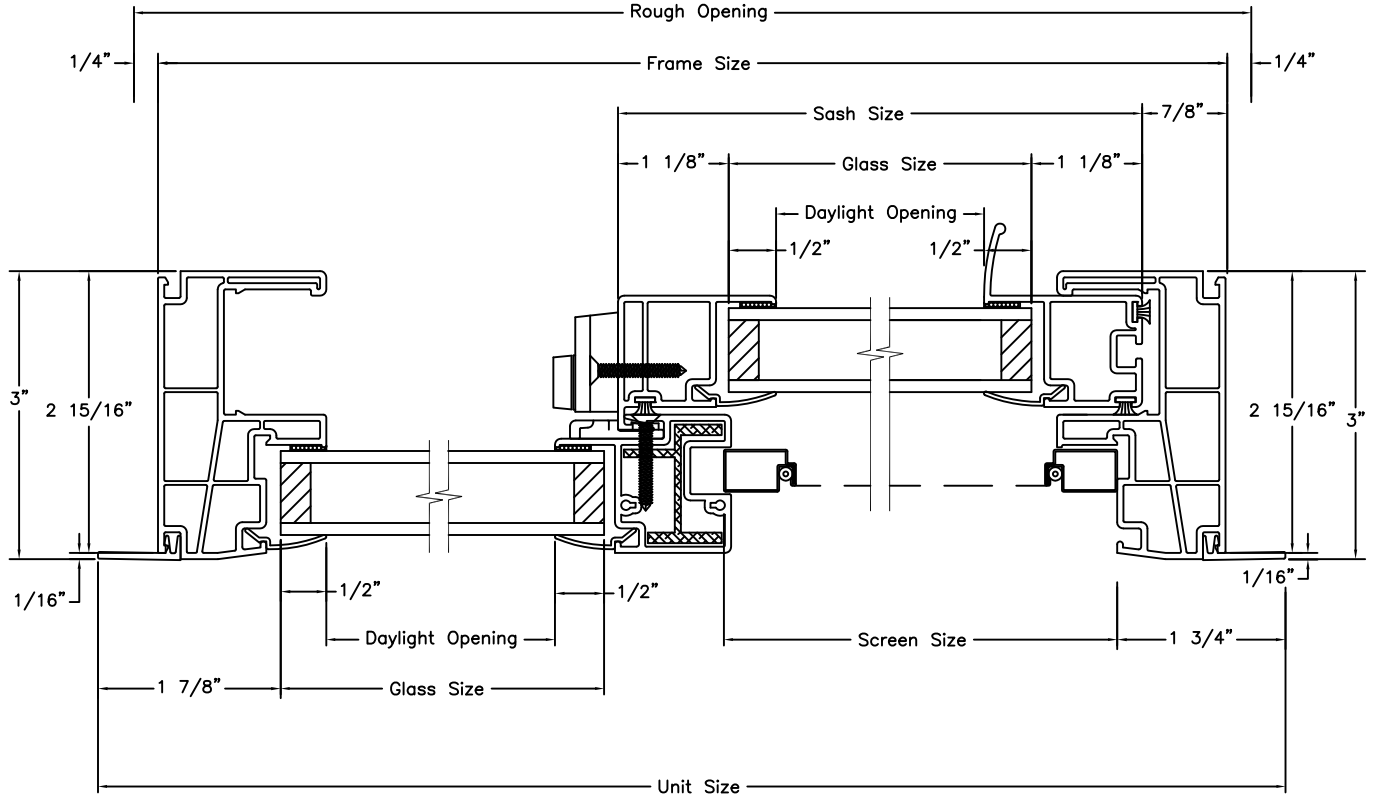

HORIZONTAL SECTION

ROLLER WINDOW POCKET

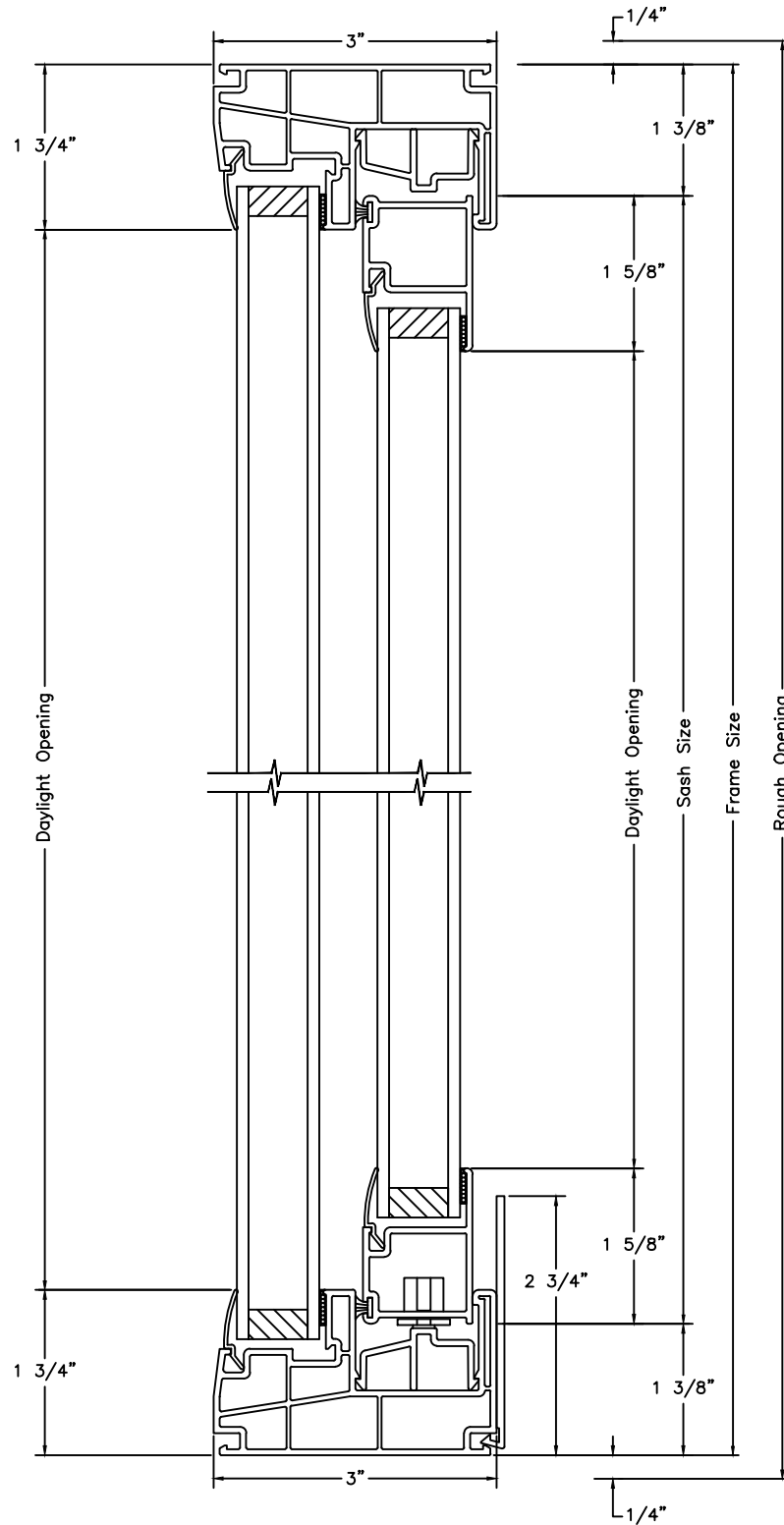

**ROLLER WINDOW
POCKET**

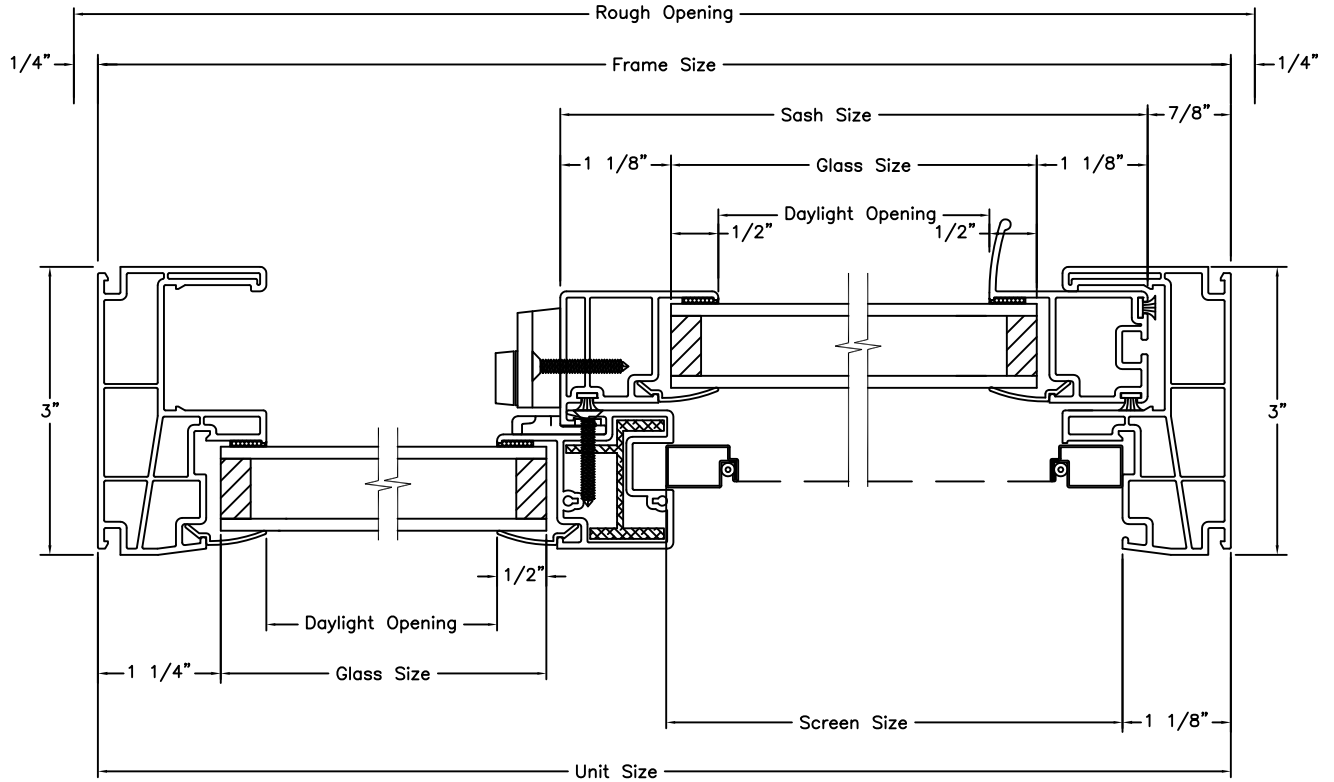

HORIZONTAL SECTION